

# SaferSphere *Today*



**[3]** Editor's Welcome - Mike Forsyth

**[4]** Wins & Completions

**[6-7]** What is BIM?

**[8-9]** Latest news

**JOIN OUR MAILING LIST**

EXPERIENCE  
RANGING FROM  
MINOR PROJECTS  
OF £20K THROUGH  
TO MAJOR  
DEVELOPMENTS  
TO THE VALUE  
OF £500M



SaferSite:SaferSphere  
[www.safersphere.co.uk](http://www.safersphere.co.uk)



EXPERIENCE  
RANGING FROM  
MINOR PROJECTS  
OF £20K THROUGH  
TO MAJOR  
DEVELOPMENTS  
TO THE VALUE OF  
£500M.

# OUTSOURCED SAFETY SUPPORT AT A FRACTION OF THE COST

## CONTRACTOR SAFETY SUPPORT

Safer Sphere appreciates that the CDM Regulations 2015 and Health and Safety Legislation can be a burden to small and medium sized contractors. Such organisations rarely have the resource to employ internal Health and Safety professionals, meaning the burden is applied to those managing the organisation or supervising construction activities.

Our aim in this department is to reduce that burden by providing compliant Contractor CDM Safety Support, which enables contractors to make Health and Safety a simple process and gives them ability to concentrate their efforts in providing quality and cost effective solutions in their chosen field. Whether you are a "contractor" or acting as "Principal Contractor", Safer Sphere are here to help you!

### THE RANGE OF SERVICES AVAILABLE FOR CONTRACTOR CDM SAFETY SUPPORT INCLUDE:

#### LITE PACKAGE

- Provision of Competent Person in accordance with Regulation 7 of the Management of Health & Safety at Work Regulations 1999.
- Annual audit of client competent health & safety advisor Reg 7 certificate.

- Access to advice by phone and email.
- Monthly safety bulletin

#### STANDARD PACKAGE *Lite Package Plus*

- Fully compliant Safety Management System.
- Monthly site audit.
- Accident and Incident investigations.
- Annual office / premises risk assessment and fire risk assessment.

#### PREMIER PACKAGE *Standard Package Plus*

- 1No. additional project site audit per month.
- Development of up to 2No. bespoke risk assessments / method statements / COSHH assessments.
- Assistance in obtaining or maintainingSSIP accreditation.
- Attendance at annual management meeting to review organisational H&S.

If the packages do not suit your particular needs then Safer Sphere can develop a bespoke subscription to suit your requirements, with additional ad-hoc services available when and where you need them.

Please contact Safer Sphere for any health & safety consultancy service  
fee quotations on **01744 768023** or email: **info@safersphere.co.uk**

# welcome!!



**THIS** month's Safer Sphere Today provides an insight into our business and provides topical bulletins. Included in this edition is an article on Building Information Modelling(BIM) and what it is all about.

Safer Sphere also shines the spotlight on the Worcester Hospital project when we look at the latest project case study. Safer Sphere operate nationally from our headquarters in the North West. If you have a need for any business or project support please do get in contact with our team.

**Kind Regards**

**Mike Forsyth**

**T** 01744 768023

**E** [info@safersphere.co.uk](mailto:info@safersphere.co.uk)

**W** [www.safersphere.co.uk](http://www.safersphere.co.uk)

**JOIN OUR MAILING LIST**





# wins & completions..

## PROJECT ORPHEUS

### CLIENT

PEEL MEDIA/ BUCKINGHAM GROUP

### SERVICES

CLIENT CDM ADVISOR AND PRINCIPAL DESIGNER ADVISOR

*THE PROJECT WILL SEE THE REDEVELOPMENT OF AN EXISTING BROWN FIELD SITE INTO A STATE OF THE ART MANUFACTURING FACILITY. THE WORKS WILL INCLUDE THE CONSTRUCTION OF A STEEL FRAME BUILDING WITH A HIGH BAY WAREHOUSE CONNECTED. THE WORKS WILL ALSO INCLUDE THE DEMOLITION OF AN ELECTRICAL SUBSTATION TO THE SOUTH OF THE SITE AND ALL OTHER SURROUNDING WORKS*

WON

## THE NORTHERN PUB

### CLIENT

URBAN VILLAGE BARS/ RECOM SOLUTIONS LTD

### SERVICES

PRINCIPAL DESIGNER ADVISOR

WON

## WORCESTER HOSPITAL

### CLIENT

ENGIE

### SERVICES

PRINCIPAL DESIGNER ADVISOR

*FUEL TANK AND COMBINED HEATING PLANT INSTALLATION.*

WON

## ORANGE TOWER LEVELS 7-10 CATEGORY A FIT OUT

### CLIENT

MEDIA CITY UK

### SERVICES

CLIENT CDM ADVISOR

### COMPLETED WORKS SO FAR:

*THE WORKS ARE FOR THE STRIP-OUT AND SUBSEQUENT FIT-OUT WORKS TO THE MAIN RECEPTION AREA OF THE ORANGE TOWER WITHIN MEDIA CITY IN SALFORD.*

WON

## GLOVERS COURT

### CLIENT

DDC DEVELOPMENTS

### SERVICES

PRINCIPAL DESIGNER ADVISOR AND CLIENT CDM ADVISOR

*CONVERSION OF FORMER WAREHOUSE INTO RESIDENTIAL APARTMENTS.*

WON



## TIMBER WHARF

### CLIENT

RECOM SOLUTIONS

### SERVICES

PRINCIPAL DESIGNER  
ADVISOR

*LED REPLACEMENT  
SCHEME (RESIDENTIAL  
BUILDING) MANCHESTER*

WON

## ROSSETTI PLACE

### CLIENT

RECOM SOLUTIONS

### SERVICES

PRINCIPAL DESIGNER  
ADVISOR

*LED REPLACEMENT  
SCHEME (RESIDENTIAL  
BUILDING) MANCHESTER*

WON

## UNITY PLACE

### CLIENT

RECOM SOLUTIONS

### SERVICES

PRINCIPAL DESIGNER ADVISOR

*LED REPLACEMENT SCHEME  
(RESIDENTIAL BUILDING)  
LIVERPOOL*

WON

## CALDERDALE HOSPITAL

### CLIENT

REDWORTH ASSOCIATES

### SERVICES

PRINCIPAL DESIGNER ADVISOR  
(STAGES RIBA 1 – 4)

*PROJECT CONSISTS OF CRH  
REPLACEMENT OF THEATRES 3 & 4  
AHU'S AND UCV'S*

WON

## LEIGHTON HOSPITAL PHASE 3

### CLIENT

MID CHESHIRE HOSPITAL TRUSTS

### SERVICES

PRINCIPAL DESIGNER ADVISOR

*THE WORK IS TO THE EXTERNAL  
HOSPITAL CAR PARK*

WON

## MANCHESTER UNITED FOOTBALL GROUND (TRAINING ACADEMY)

### CLIENT

FAIRHURST GROUP

### SERVICES

PRINCIPAL DESIGNER ADVISOR

*THE EXISTING ACADEMY HAS A ROOM  
KNOWN AS REHAB ROOM THIS IS GOING  
TO BE REFURBISHED INTO A TEACH ROOM  
WITH CAT B WORKS WITHIN THE ROOM  
AND MINOR STRUCTURAL ALTERATIONS  
ON THE ADJACENT CORRIDOR.*

COMPLETED

wins & completions...

# WHAT IS BIM?



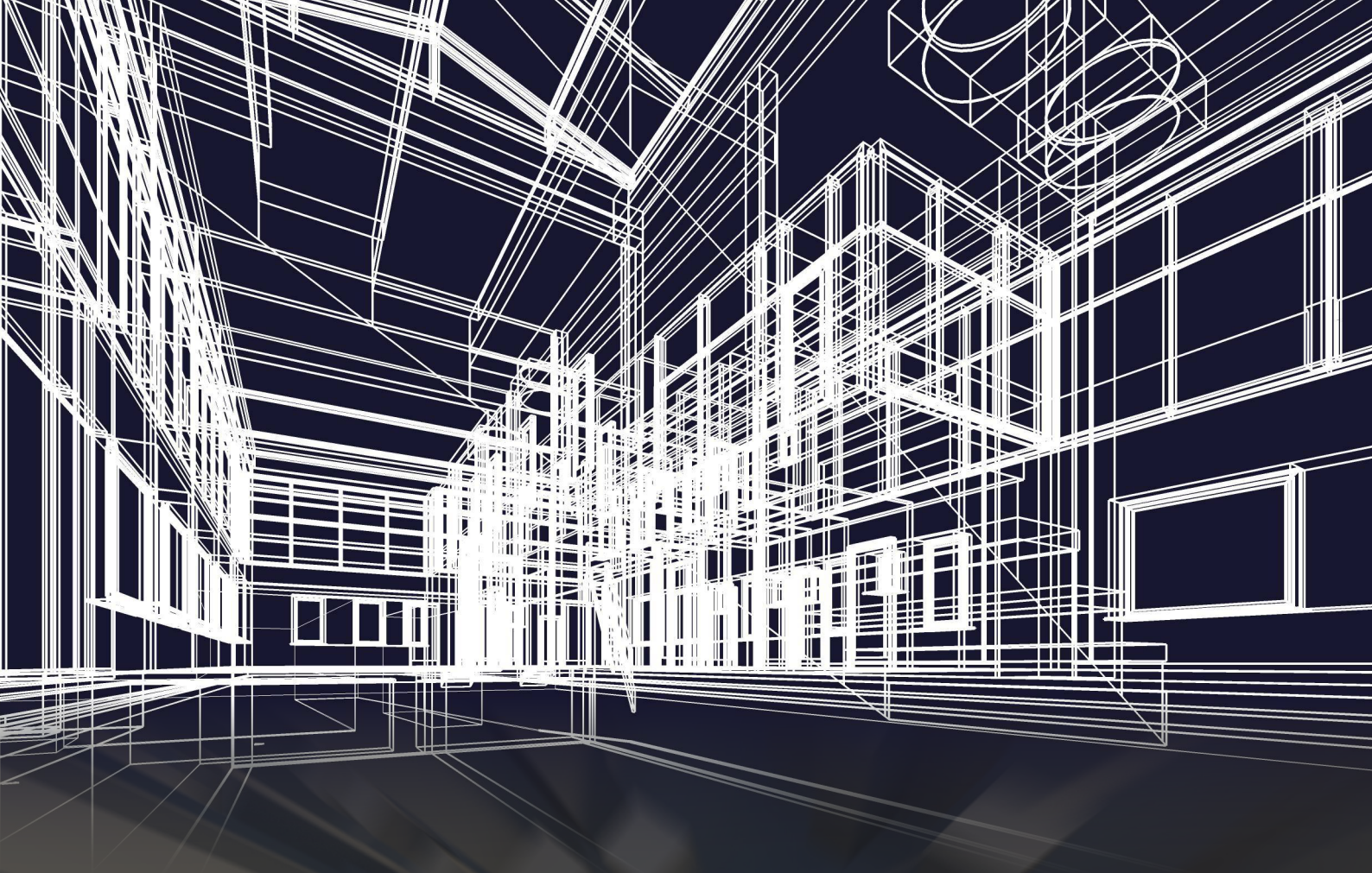

**BIM** is an acronym that stands for Building Information Modelling. BIM is very much talked about these days in the building industry, but when asked you will receive different definitions from different people.

Some say BIM is a type of software. Some say BIM is the 3D virtual model of buildings. Others say BIM is a process or BIM is nothing more than the collection of all building data organized into a structure database easy to query both in a “visual” and a “numerical” way. It is safe to say that BIM is all the above and some more. What BIM is not is a specific piece of software i.e. Revit, Archicad etc, it is a process.

The definition which is most commonly used is that as developed by the Construction Project Information Committee (CPIC) as the: ‘.digital representation of physical and functional characteristics of a facility creating a shared knowledge resource for information about it forming a reliable basis for decisions during its life cycle, from earliest conception to demolition.’

The National BIM Survey 2016 predicts that BIM adoption in the construction industry in the UK will rise from 56% in 2016 to 97% in just 5 years.

It is good news that BIM usage is increasing, but it should not be used as a tick box exercise, but is seen as an important tool for collaboration

and delivering tangible benefits for the whole of the design, construction and client team. The CDM Regulations 2015 place great emphasis on clients, designers, contractors, Principal Contractors and Principal Designers to co-operate with each other and outside agencies, the use of BIM can help facilitate this by using a common source of information, which is agreed and updated to show amendments and changes as they occur, and which is communicated to all parties via the single model.

When it comes to BIM everything starts with a 3D digital model of the building. This model, however, is way more than pure geometry and some nice textures cast over it for visualization. A true BIM model consists of the virtual equivalents of the actual building parts and pieces used to build a building. These elements have all the characteristics - both physical and logical - of their real counterparts. These intelligent elements are the digital prototype of the physical building elements such as walls, columns, windows, doors, stairs etc. that allow us to simulate the building and understand its behaviour in a computer environment way before the actual construction starts. Nevertheless, with the advent of mobile technologies such as smart phones/tablets and the likes utilisation of BIM has broken out from the close circle of professionals.

Clients, building owners and operators are getting more and more access to BIM models through their mobile devices even without the need to installing a BIM application first. As the CPIC definition notes the whole life cycle of a structure can be encapsulated within a BIM model, this includes the construction methods and sequencing for the construction, maintenance and demolition. And all this information can be used to ensure that H&S considerations are addressed from concept to construction. Designers can scrutinise the “virtual” building to determine hazards and plan how to handle them in advance of construction. The logistics of site deliveries, vehicle and plant movements, or the phasing of construction works, can be more safely co-ordinated. The contractor, temporary works co-ordinators and designers can use the model to assess lifting plans, scaffold zones and site access and egress by adding in widely available 3d models of cranes, lorries etc which can be tracked to show and inform lifting plans and site movements to ensure they can be achieved safely. In addition, as the life of a BIM model extends beyond the construction phase, it can help facilities management teams to check for safe access for operation and maintenance, or to plan strategies for future refurbishment, modification or ultimately demolition work.





## BRITAIN'S ANNUAL INJURY AND ILL HEALTH STATISTICS RELEASED

**The latest annual injury and ill health statistics from the Health and Safety Executive (HSE) show 1.3 million workers were suffering from work related ill-health and there were 609,000 workplace injuries in 2016/17.**

**THE FIGURES** show that while Britain remains one of the safest places to work, there is still work to do to drive figures down.

Workplace injury and new cases of ill health cost Britain £14.9bn a year with 31.2 million working days lost. The annual statistics, compiled by HSE from the Labour Force Survey (LFS) and other sources, cover work-related ill health, workplace injuries, working days lost, costs to Britain and enforcement action taken.

Top line statistics show that in 2016/17 there were;  
137 fatal injuries in Britain's workplaces  
70,116 other injuries reported by employers  
12,000 lung disease deaths estimated to be linked to past work exposures  
554 cases prosecuted with fines from convictions totalling £69.9 million

Martin Temple, HSE Chair, said of the findings:  
"These latest figures should act as a spur to reduce the

impact of ill-health and injury on Britain's workforce and businesses and we cannot rest on our reputation.

"We will only achieve long term improvement by a collective approach to improve workplace standards. Poor standards lead to poor health and increased injuries which is bad for the workforce and business."

Though there were fewer prosecutions taken in 2016/17, the statistics show an increase in fines to £69.9 million from the 2015/16 total of £38.8 million. New sentencing guidelines in England and Wales were introduced in 2016. Twenty large fines accounted for £30.7 million of the new figure.

Fines are not collected by HSE but are levied by the courts in criminal cases and paid to HM Treasury.

**The full annual injury and ill-health statistics report can be found at: <http://www.hse.gov.uk/statistics/>**

## BUILDER FINED AFTER WORKER FELL FROM HEIGHT

**A BUILDER** has been fined after a worker suffered serious injuries after falling from height from a scaffold. Derby Magistrates' Court heard that on 22 April 2017, a worker for Nicholas Lawrence Birkin fell five metres from scaffolding at a construction site in Heanor, Derbyshire. He suffered deep lacerations to his face which required 40 stitches along with a fractured eye socket and wrist. An investigation by the Health and Safety Executive (HSE) found the worker, who was working under the control and direction of Mr Birkin, was using an electric hoist and wheelbarrow to lift roof tiles up to the scaffold platform. The scaffold guard rails had been removed from a 1.6 m wide section to facilitate the lifting operation. The worker fell from the scaffold while attempting to tighten the fittings securing the hoist.

Nicholas Lawrence Birkin of Beach Road, Nottingham pleaded guilty to breaching Regulation 6(3) and Regulation 8(a) of the Work at Height Regulations 2005. He has been fined £2400 and ordered to pay costs of £840. Speaking after the hearing HSE inspector Andrew Bowker said: "Those in control of work at height have a responsibility to ensure that safe methods of work are used. "This incident could have been fatal, Mr Birkin failed to provide other means of falls protection once the scaffold guard rails had been removed. "Following the accident, the defendant hired in a conveyor type tile hoist which has enabled the job of lifting roof tiles to be done with the scaffold guard rails still in place. This has delivered both a safer and more productive site at relatively little cost."

SOURCE: [HTTP://PRESS.HSE.GOV.UK/](http://press.hse.gov.uk/)

## DEMOLITION COMPANY AND DIRECTOR SENTENCED AFTER WORKER INJURED

**A DEMOLITION COMPANY** and its director have been sentenced after a worker suffered crush injuries when his arms were trapped between two 10 tonne steel girders. Liverpool Crown Court heard how an employee of S. Evans and Sons Limited was injured when the managing director, who was operating machinery to stack the girders, dropped one of the girders onto the employee's arms, resulting in amputation to the employee's left arm and right hand.

An investigation by the Health and Safety Executive (HSE) into the incident, which occurred on the 19 October 2015, found the company failed to apply appropriate control measures including ensuring the right equipment for the task was used. The managing director, Samuel Evans, was directly involved in the incident and found personally responsible for both the choice in equipment and the manner in which the task was performed.

S. Evans and Sons Limited of Ditton Road, Widnes pleaded guilty to breaching Section 2(1) of the Health

& Safety at Work Act 1974 and Regulation 4(3) of the Provision and Use of Work Equipment Regulations 1998. The company has been fined £150,000 and ordered to pay costs of £9,523.04. Company director, Samuel Evans, pleaded guilty to breaching two counts of Section 37 of the Health and Safety at Work Act 1974, in relation to the company's failing of Section 2(1) of the Health & Safety at Work Act 1974 and Regulation 4(3) of the Provision and Use of Work Equipment Regulations 1998.

Samuel Evans was sentenced to ten months imprisonment, suspended for two years and ordered to complete 200 hours of unpaid work.

HSE inspector Rohan Lye said after the hearing: "If the company and its director had taken basic steps to decide how to do this routine task, and what control measures to use, they could have prevented this devastating incident resulting in an employee suffering life-changing injuries."

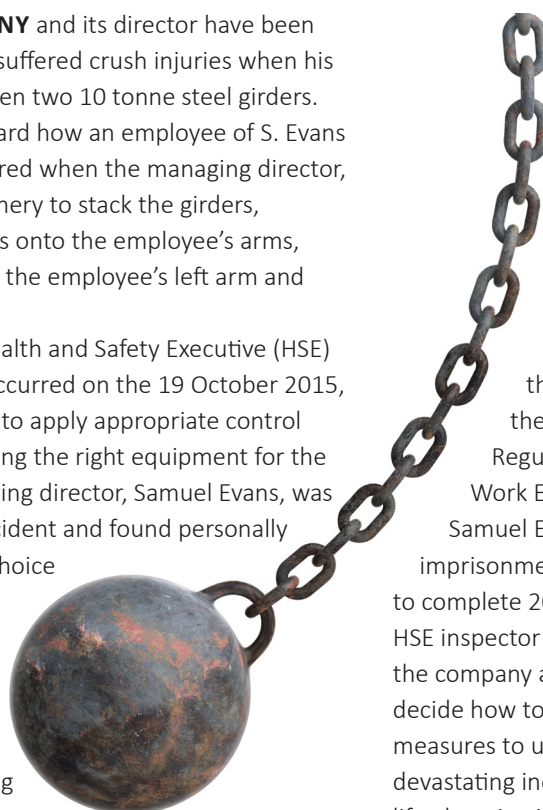

SOURCE: [HTTP://PRESS.HSE.GOV.UK/](http://press.hse.gov.uk/)





## CLIENT

Worcester Royal  
Hospital / Cofely FM

## SERVICES PROVIDED

Client CDM Advisor

## SERVICE PERIOD

May 15 - project still  
ongoing in other areas

## PROJECTS

Worcester Hospital  
Refurbishment

## TESTIMONIAL

Peter Sleightholme  
-Worcester Hospital

## SERVICES

### CONSTRUCTION HEALTH & SAFETY, ADVISORS AND PRINCIPAL DESIGNER ADVISORS

#### Service Description

Safer Sphere were appointed as Client CDM Advisor for the refurbishment of Worcester Hospital. The project included the pre-installation for a new Siemens Fluoroscopy unit room and an extension to the existing facility at basement level. The works consisted of the removal and re-installation on completion of existing lead screen, removal of the existing floor coverings, ceiling tiles, fitted furniture removed and replaced, walls decorated and alterations to the existing Uni Strut grid. In addition to the building works all mechanical and electrical works to the Siemens unit was required. The extension to the basement works comprised the strip, sub-structure, superstructure install / mods, fit out, services and external works.

The scope of our services included:-

- Pre-Contract reviews with sub-contractors and packages;
- Reviews of high risk activities and applicable safe systems of work for enabling packages;
- Advising on compliance with organisational operating procedures and minimum standards;

#### Service Challenges

Whilst the client and design team have led the design with best practice CDM principles, some of the key challenges included:-

- Reconfiguration of existing building;
- Working in a live hospital facility;
- Harmful dust hazards.







# IS YOUR PROJECT COMPLIANT?

## CDM CLIENT SUPPORT SOLUTIONS

**SAFER SPHERE HAS AN ARRAY OF EXPERIENCE IN DELIVERING CDM SUPPORT IN ACCORDANCE WITH THE CDM REGULATIONS 2015.**

We pride ourselves on delivering above and beyond the call of the CDM Regulations, our integration with the client project delivery teams and support provided to enable best practice solutions. Our delivery model ensures a superior service, competent advice and ultimately a project that meets with the very best practices of Construction Health & Safety.

### **CDM 2015 PROJECT CDM CONSULTANT SERVICES INCLUDE:-**

Acting as adviser to the Client in discharging their duties including:-

- Notify the HSE of the project via an online applications.
- Advise on and or collate the project Pre Construction H&S Information Pack on behalf of the client for issue to the project team.
- Assist with preparation of and advise the client as to the adequacy of the Construction Phase H&S Plan and welfare facilities developed by the

Principal Contractor.

- Monitoring of Principal Designer and Principal Contractor compliance.
- Advise on and or collate the project H&S File.

### **ADDITIONAL SERVICES WHICH A CLIENT MAY ALSO WISH TO CONSIDER:-**

- Stage 1 & Stage 2 Competence Assessments of duty holders against the requirements of PAS 91.
- PQQ / ITT H&S question setting for framework and or project tender enquiries.
- Independent Site Inspection and or Safety Audits of operations on site to ensure compliance.
- Liaison support with the Health & Safety Executive on behalf of the client.
- Client CDM training to assist client representative in understanding their duties under the CDM Regulations.
- Preparation of model contract / appointment clauses to hold designers and contractors to their duties and compliance.

Please contact Safer Sphere for any health & safety consultancy service fee quotations on **01744 768023** or email: **info@safersphere.co.uk**

# YOUR LEADING FULL SERVICE CDM & CONSTRUCTION HEALTH & SAFETY CONSULTANTS

CONTRACTOR CDM SAFETY SUPPORT

CDM CLIENT SUPPORT

E-LEARNING

PRINCIPAL DESIGNER CONSULTANCY

MONTHLY SAFETY BULLETIN

**Safer Sphere** are the provider of choice for competent, professional and holistic Construction Health & Safety Solutions with a difference. We are specialist CDM Consultants in all areas of health and safety in construction including Construction Design & Management (CDM) and Project Health and Safety (H&S).

Our focus is to assist the industry in compliance through best practice, to provide simple and innovative solutions to a clients needs. As one of the leading CDM consultants and Construction Health & Safety consultants we are driven by our commitment to clients, our belief that we can always improve on what has gone before and that we can truly deliver the ability for us all to operate within a Safer Sphere.

*"Our focus is to assist the industry in compliance through best practice, to provide simple and innovative solutions to a client's needs."*

**MIKE FORSYTH**  
MANAGING DIRECTOR

EXPERIENCE  
RANGING FROM  
MINOR PROJECTS  
OF £20K THROUGH  
TO MAJOR  
DEVELOPMENTS  
TO THE VALUE OF  
£500M.

